

ASSEMBLY INSTRUCTIONS



BEFORE FIRST USE, READ THE OPERATING AND INSTALLATION INSTRUCTIONS

Manufacturer:

The Hitze brand is owned by
STALKO Spółka z ograniczoną odpowiedzialnością sp. k.
ul. Solec 24/253, 00-403 Warszawa

OFFICE / WAREHOUSE:
32 Gdyńska Street, 26-600 Radom
Hotline: +48 800 880 030

www.hitze.pl



Dear Customer,

Thank you for purchasing a product from the Hitze range!

Warmth from Nature - these words perfectly illustrate the Hitze brand philosophy. In line with this, we manufacture fireplaces and cookers. Thanks to modern technology, we have created innovative solutions that are characterised by a modern design and high heating efficiency.

We wish you trouble-free operation and plenty of warmth!

Before installing and connecting the fitting to the heating system, it is essential to read the operating and installation instructions and check the completeness of the product components.

The information in the **User's Manual and Installation Booklet** will ensure correct operation of the fireplace stove and cladding and will help prevent damage and accidents due to improper use.

If you have any doubts or operating problems, please contact your point of sale or Produ- cent.

FOR THE INSTALLER: Leave the manual with the appliance.

FOR THE OWNER: Retain this manual for future use.

The instructions are to be made available to each user together with the building prior to installation or dismantling.

U W A G A



1. ***DANGER OF BURNS! THE GLASS AND PARTS OF THE FIREPLACE SURROUND MAY BE VERY HOT.***
2. ***DO NOT TOUCH THE APPLIANCE AND THE HOUSING UNTIL THEY HAVE COOLED DOWN COMPLETELY.***
3. ***NEVER LEAVE CHILDREN OR PETS UNATTENDED IN FRONT OF A BURNING OR JUST EXTINGUISHED FIREPLACE.***
4. ***THE APPLIANCE MUST NOT BE USED BY CHILDREN.***
5. ***IT IS FORBIDDEN TO LEAVE ANYTHING FLAMMABLE OR HEAT-SENSITIVE (CLOTHING, FURNITURE, FLAMMABLE FUELS, ETC.) IN THE VICINITY OF THE FIREPLACE STOVE AND THE BUILDING.***

Before installing the structure and connecting the gas insert to the heating system, it is essential to read the operating and installation manual and check the completeness of the product components.

The information contained in these Operating and Installation Instructions will ensure the correct operation of the gas cartridge and the installation and will help to avoid damage and accidents caused by improper use.

If you have any doubts or operating problems, please contact your point of sale or the Manufacturer.

In order to improve the product, the manufacturer reserves the right to make changes to the drawings, photographs and descriptions, as well as to the parameters of the equipment, without prior notice and at any time.

The Operating and Assembly Instructions may not be copied in whole or in part without the Manufacturer's authorisation. Keep the operating **and assembly instructions out of the reach of children.**

In the event of damage, loss or destruction of the User's Manual and Installation Manual, please request a copy from the point of sale or the Manufacturer, providing the identification details of the appliance.

INSTALLATION INSTRUCTIONS

CALMA GAS FIREPLACE

Table of contents

GENERAL INFORMATION.....	4
SECURITY	4
INSTALLATION	6
SELECTION OF THE LOCATION OF THE CARTRIDGE WITH THE BUILDING-IN SYSTEM	6
CONNECT	6
PANEL MARKINGS	6
MONTAGE	7
CONSERVATION	15

*This manual is protected by copyright. All rights reserved. The manufacturer reserves the right to make corrections and amendments to the manual without any notification to anyone. The version of the manual should be verified with the version on **www.hitze.pl**.*

GENERAL INFORMATION

Important: Keep these instructions!

- The rigidity of the structure and its individual components should be checked to verify that it has no damage;
- Any fitted appliance is subject to periodic chimney sweeping. The appliance must be inspected or serviced by a qualified chimney sweep/sweep. Failure to comply with these rules may lead to personal injury, property damage or even death;
- Regulations, national and local standards must be observed during assembly, installation and operation;
- It is required that the installation of the fireplace stove is carried out by a qualified person or company and that technical acceptance is carried out by a master chimney sweep and a fire specialist;
- Consult your authorized dealer or building inspector to determine which regulations apply to the user and the installation of the appliance at the place of installation of the built-in unit and insert;
- It is strictly forbidden to use the device if one of its components is removed or damaged. In the event of damage, the component must be replaced with a new original one as indicated by the manufacturer;
- Ensure that the installation and operation of the unit does not require permits;
- It is imperative that the instructions and the fire safety code are followed in the absence of provisions governing installation and use.

SECURITY

If you comply with the following rules, the fireplace stove will operate correctly and damage and accidents due to improper use will be avoided.

For the necessary safety rules to be observed:

- it is absolutely necessary to take care when using the fireplace stove. All visible surfaces can be very hot during burning, as well as up to several hours after the fireplace stove has gone out. It is forbidden to touch them;
- use heat-resistant gloves for all work on the fireplace;
- Due to the high temperatures of the fireplace stove and particularly the glazing of the fireplace stove, great care must be taken with the positioning of flammable materials. All flammable items must be kept at a safe distance from the fireplace stove and the components of the cladding.
- inform all members of the household of the presence of high temperatures on the appliance while it is burning, as well as up to a few hours after it has finished burning, in order to prevent scalding as well as the ignition of clothing (special attention should be paid to children and disabled persons).
- before installing or maintaining the cartridge, read the Operating and Assembly Instructions with comprehension;
- Install the fireplace stove in the most convenient location while observing current building and fire regulations;
- installation, maintenance and functional testing of the system should be carried out by qualified specialists;
- use the appliance for its intended purpose;

- it is essential to ensure adequate ventilation and air supply at the insertion point;
- Place the clothes dryer at a minimum distance of 1.5m from the insert (fire hazard);
- check the permissible load on the substrate (floor, ceiling) at the planned insertion point (taking into account the
- the total weight of the appliance including the body);
- provide a suitable chimney installation to ensure safe operation (e.g. a chimney made of flame-retardant materials that do not absorb heat);
- avoid installing the insert in rooms with B-gas appliances, hoods (with and without exhaust), heat pumps, collective ventilation ducts, numerous active smoke ducts, as well as in the vicinity of stairwells and rooms with appliances capable of creating negative pressure;
- avoid direct contact with the insert (the appliance heats up to high temperatures during operation), and if necessary use suitable protective equipment (clothing, heat-resistant gloves);
- Install in rooms with fire protection and equipped with air, water, electricity and exhaust;
- in the event of any difficulties, contact your dealer or the manufacturer (in the event of repair, request original spare parts);
- periodically check and clean the flue pipe in accordance with the regulations in force;
- Include operating and installation instructions in case the unit is sold or rented.

Never:

- lean against and climb on the cartridge and the elements of its construction;
- use the appliance in the event of faults or malfunctions;
- leave flammable materials within 1.5m of the fireplace;
- light fires with flammable materials and burn waste;

Hitze is exempt from civil and criminal liability in the event of:

- if the insert is not used in accordance with the Operating and Installation Instructions;
- modification of the fireplace stove and unauthorised substitution of non-original parts (these actions lead to the immediate cancellation of the guarantee);
- injuries and damage to property caused by incorrect installation and maintenance (not in compliance with the Operating and Installation Instructions).

First steps:

- Inspect the contents of the consignment in the presence of the supplier. If you notice any damage or missing items, please contact the seller.
- It is imperative that the instructions and the fire safety code are followed in the absence of provisions governing installation and use.

■ INSTALLATION

Install the enclosure only on the cartridge dedicated to it. The enclosure has been tested for durability and safety only with a cartridge dedicated to it, and the installation should be carried out in accordance with the legal requirements in your country. In the case of regulations governing installation, the rules in the manual and fire safety rules must be followed.

■ SELECTION OF INSERTION POINT FROM

The location of the fireplace stove with cladding must be planned in advance and depend on the position of the chimney with which it will be used. In addition, the load-bearing capacity of the floor must be checked (depending on the weight of the appliance and the cladding), and the floor must be prepared in advance and made of non-combustible material. The cladding offers several possibilities of connection, so plan in advance which connection to the chimney you will ultimately choose.

■ CONNECT

The installation and operation of the appliance must comply with local and national regulations and standards as well as with the instructions in the manual of the appliance for which the appliance is installed. In the absence of local installation regulations, the instructions in the appliance manual must be observed.

■ DESIGNATIONS PANELS

To make installation easier, the panels have special cut-outs that inform us of their location: **X.Y**

X - indicates the size of the case **Y** - indicates panel number

Example: 8.1 means that it is a panel from the CALMA 80x50 model numbered 1

A description of the individual cut-outs follows.

6. - CALMA 65x80 8. - CALMA 80x50 1. - CALMA 120x50

.3 and .2 - designation of universal panels used for all types of enclosures

.10 - universal panels used for CALMA 80x50 and CALMA120x50

DP and DL - designation of decor elements used for all enclosures

D8, D6, D1 - designation of the décor elements used for the respective enclosure

MONTAGE

The appliance must be assembled in accordance with the step-by-step diagram below without omitting any of the points. Skipping one of the steps may lead to weakening of the structure, resulting in damage during operation or even life and health hazards.

Step 1.

To obtain the correct height, unscrew the feet **(1)** from the fireplace stove, screw them to the additional adjustable leg **(2)** supplied with the fireplace stove, and fasten them to the feet with the DIN603 M8x20 screws and the DIN6923 M8-5.8 flange nuts **(3)** as **shown in the diagram below (NB! You must screw the feet exactly in the positions shown in the figure)**. The exact height can be obtained via the foot adjustment screw **(1)**.

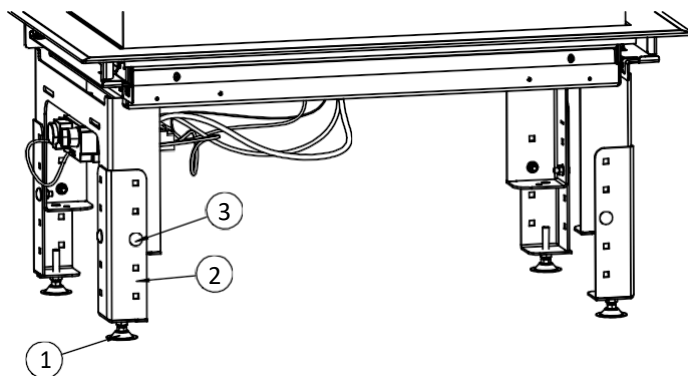

Step 2.

We assemble the left-hand bracket, the right-hand bracket **(4)** and the front bracket **(5)** using DIN603 M8x20 bolts and DIN6923 M8-5.8 flange nuts **(3)**. We then tighten the bottom back support **(6)** to the side supports **(4)** at the back with M5x6 bolts **(7)**.

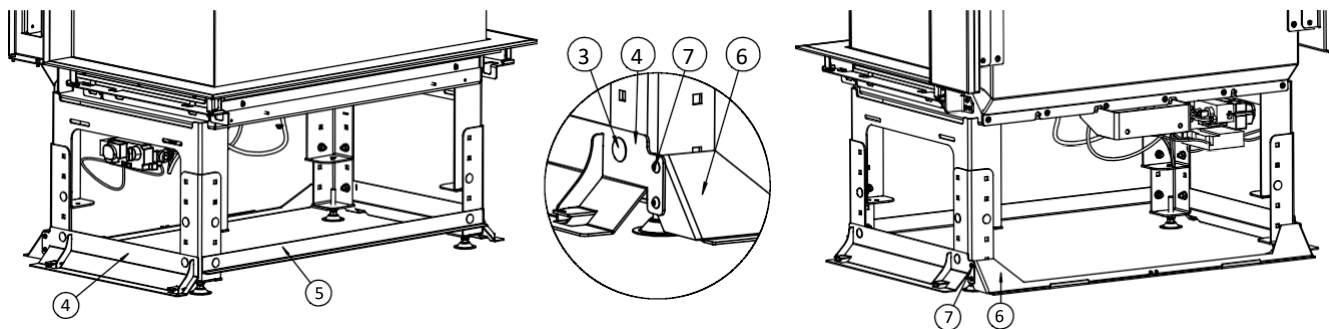

Step 3.

Mount the door frame connector **(8)** on both sides using M5x6 screws **(7)**. Fasten the right and left side connector **(9)** **with 4 M5x6 screws (7)** to the flat in the back part of the insert so that the mounting holes for screwing the back support **(10)** are at the top and outside (do not tighten them!). Screw the centre back support **(10)** to the right and left side connector **(9)** using 4 M5x6 screws **(7)**. We can tighten the right and left side connector **(9)**.

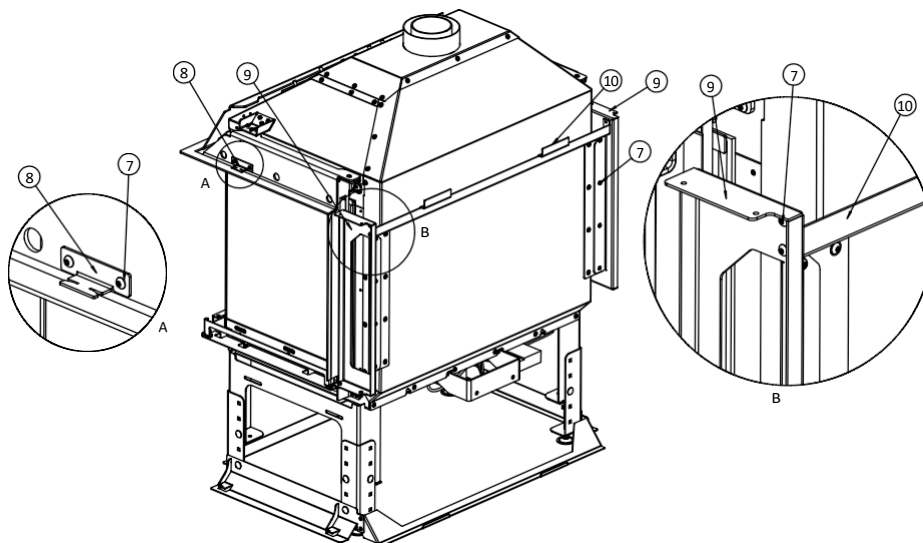

Step 4.

Assembly of lower left back **(11)** and lower right back **(12)** by fitting the projections of the bracket **(10)** and the bottom moulding into the holes on the back pieces.

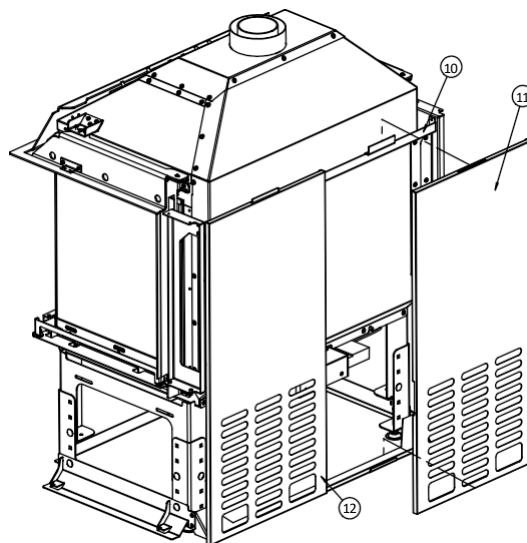

Step 5.

In this step, the two panels numbered **.2** and **.3** are to be found. The lower left and right panels (**13**) are assembled by sliding them over the protruding parts of the bracket (**4**) shown in the close-up **B**, then pushing them down and tightening them with 2 DIN 912 M5x10 screws (**14**).

(ATTENTION: The cut-outs on the side edges must be on the front side of the insert!)

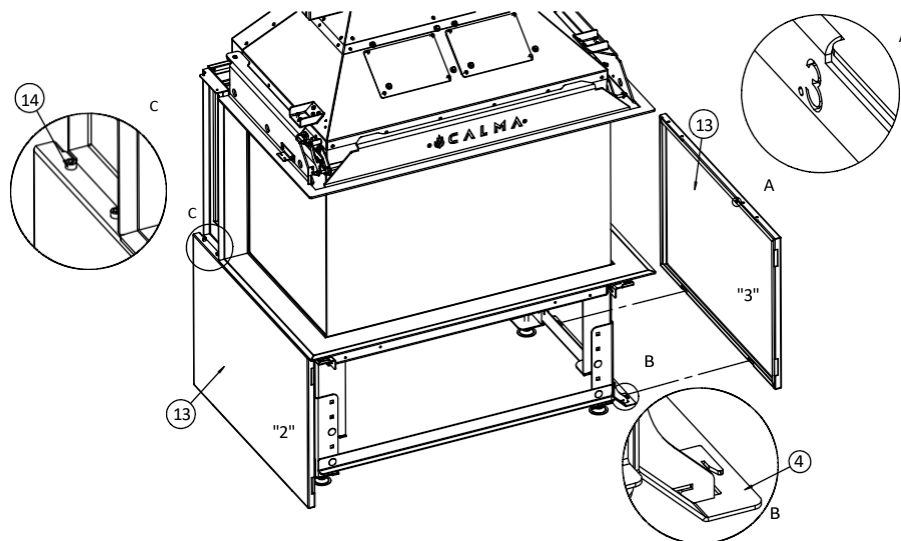

Step 6.

We find the panel marked as shown in detail **A**. Fix the front panel number **.1** (**14**) into the holes on the side panels (**13**) by pushing in. **ATTENTION: Make sure** that the marking of panel **A** is at the top of the panel and that its hooks point downwards!

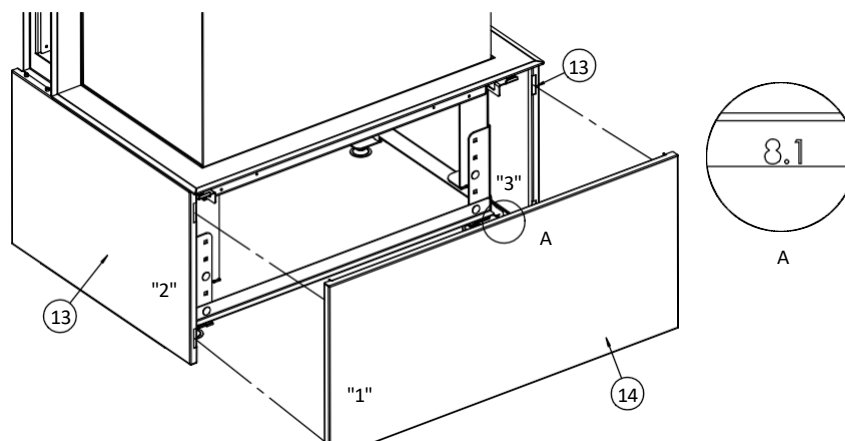

Step 7.

In this step, find the two panels marked with the cut-out numbers .5 and .6. Screw on the corner connector (15) with the M5x6 screws (7) and then screw in the DIN 912 M5x10 screw (14) with the head towards the centre (**projection A**). The left and right panels (16) are assembled by sliding them over the projections of the door frame catch (8-"Step 3"), then pushing them together and screwing them in with 2 DIN 912 M5x10 screws (14) (**projection B**).

(ATTENTION: The cut-outs on the side edges must be on the front side of the insert!)

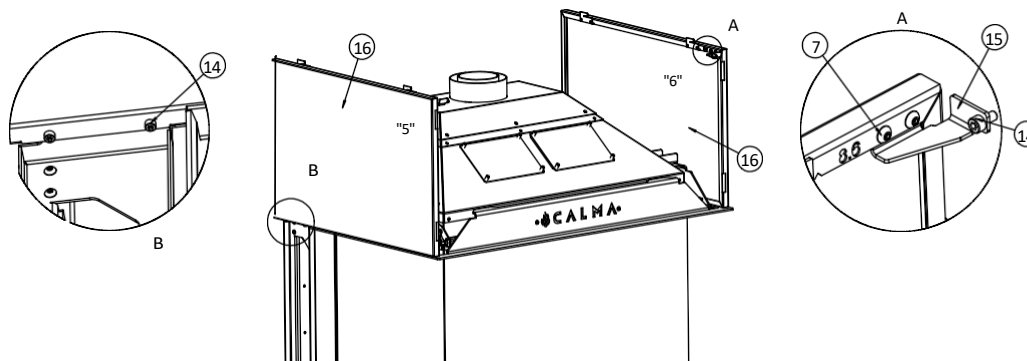

Step 8.

We find the panel numbered .4. We fix the front panel (17) into the holes on the side panels (16) by pushing it in, and the corner connector screw (15) fits into the notches on the panel (17).

ATTENTION! Ensure that the marking of panel A is at the top of the panel with its hooks pointing downwards!

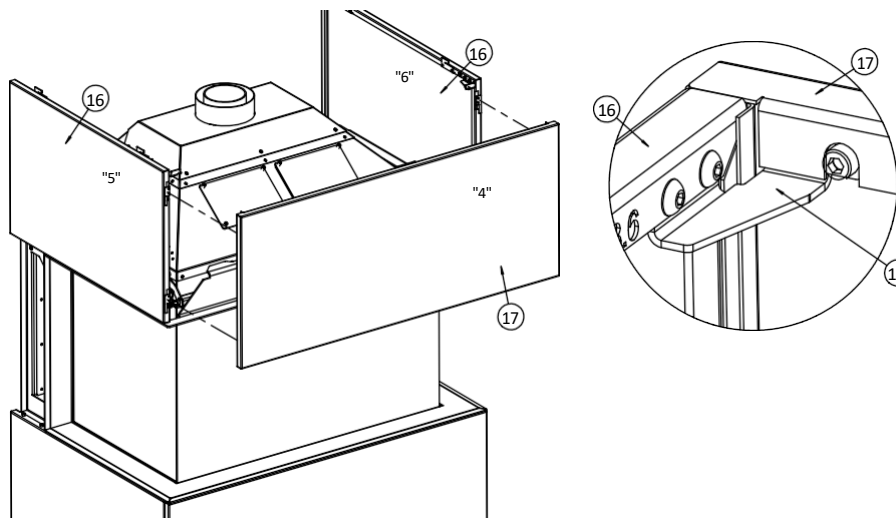

Step 9.

In this step, find two small side panels **.10** and **.11** with 4 cutouts on the shorter sides **(18)**. The panels are assembled by sliding them over the protruding heads of the DIN 912 M5x10 screws **(14)** at both the top of the panel and the bottom.

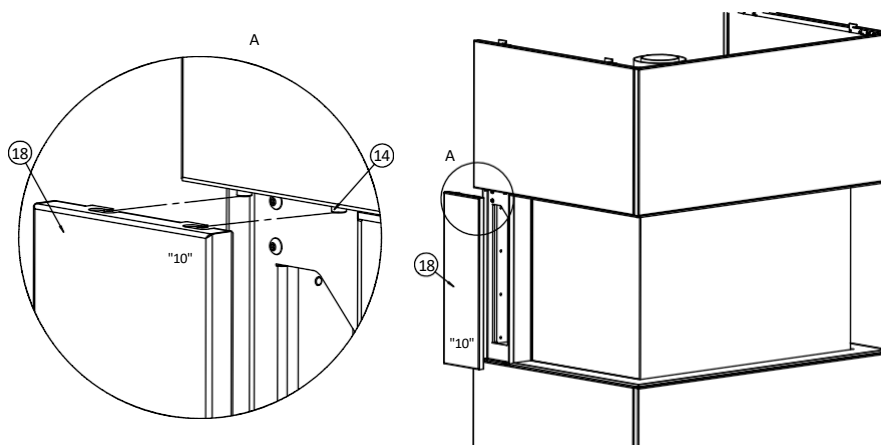

Step 10.

We find two side panels **DP** and **DL** **(19)**, a front panel (**D8, D6** or **D1** depending on the model) **(20)** and a rear panel connector **(21)**. The side panels **(19)** are screwed together with the back panel connector **(21)** using M5x6 screws **(7)** as shown in plan **B**. Once the side panels are screwed together, brace them with the front panel **(20)** by pressing the riveted lugs **(A)** into the holes located in the side of the side panels **(19)**.

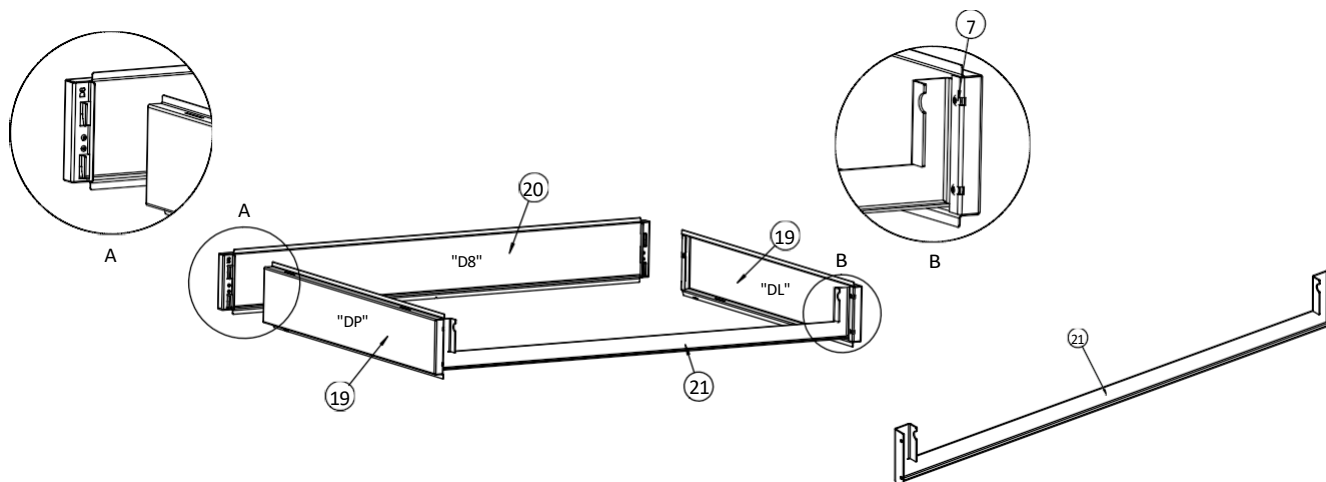

After screwing the element together, place the whole onto the pre-built enclosure in such a way that the holes in the lower part of the panels go into the hooks, and then move the whole towards the back of the enclosure until the elements interlock.

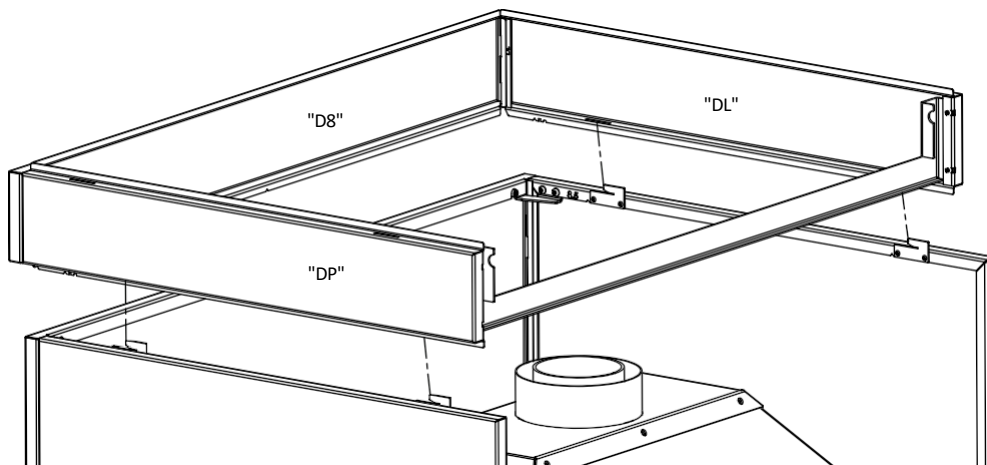

Step 10.

Prepare side panels number .8 and .9 (22), front cover bracket (23) and rear cover bracket (24). Tighten the corner connector (15) with M5x6 screws (7) and then screw in the DIN 912 M5x10 screw (14) as shown in plan A. Perform this operation on both panels. The next step is to screw both sides together using the front (23) and rear brackets (24) with M5x6 screws (7) as shown in plan B.

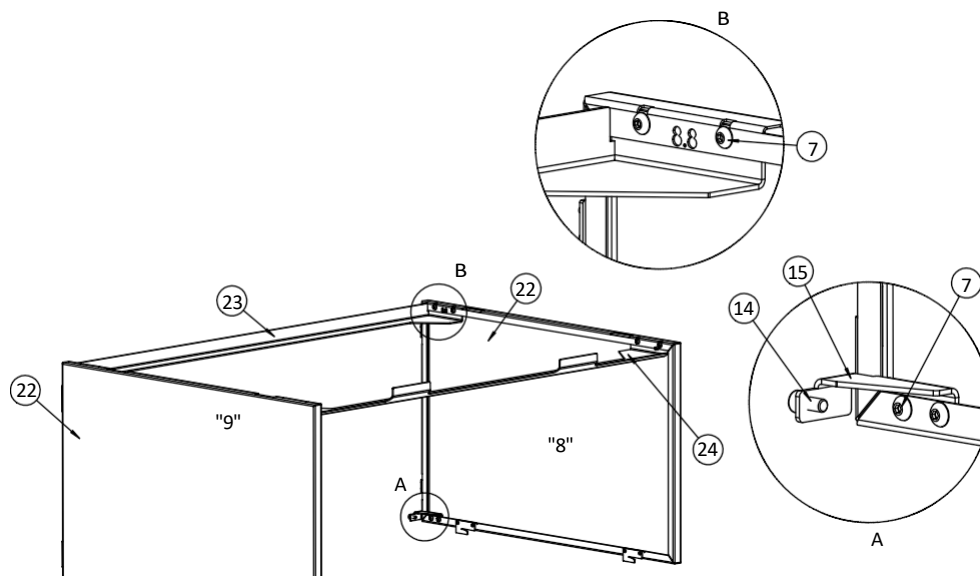

After screwing the element together, place the entire assembly on the pre-built enclosure so that the hooks on the bottom of the panels enter the holes on the enclosure, and then slide the entire assembly towards the rear of the enclosure until the elements interlock.

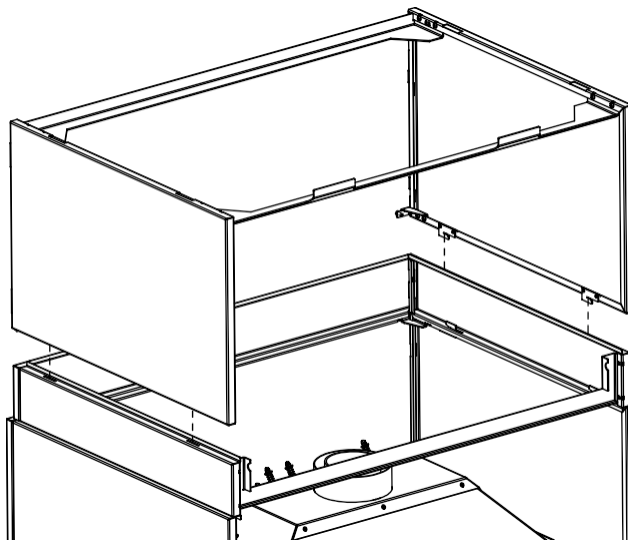

Step 11.

We find the last panel .7. We fix the front panel (25) into the holes on the side panels (22) by pressing so that the corner connector screw (15) fits into the notches on the panel (25).

ATTENTION! Ensure that the marking of panel A is at the top of the panel with its hooks pointing downwards!

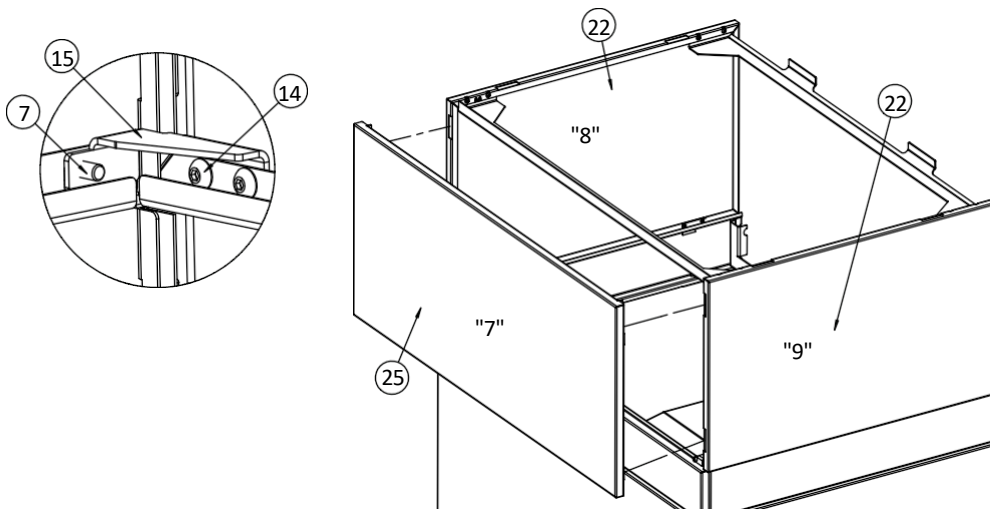

Step 12.

Fitting left bottom back **(26)** and right bottom back **(27)** by fitting the bracket projections **(24)** and the lower slat into the holes located on the back elements.

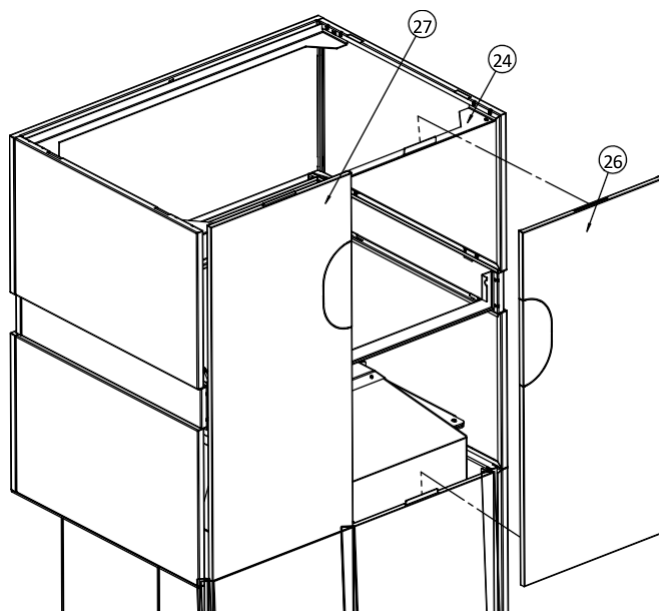

Step 13.

The final step is to attach the top covers of the housing, the left cover **(28)** and the right cover **(29)**.

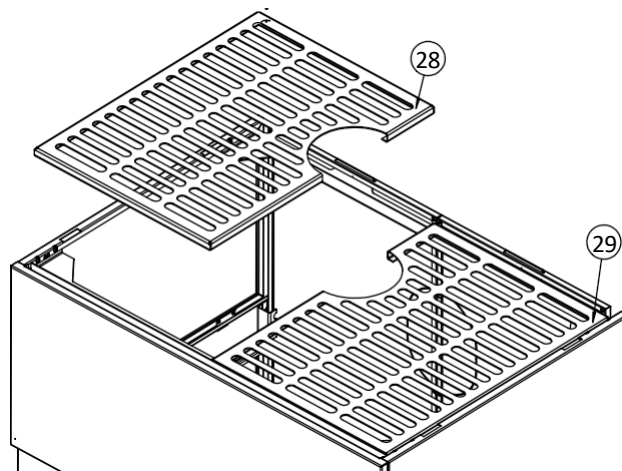

Enclosed unit.

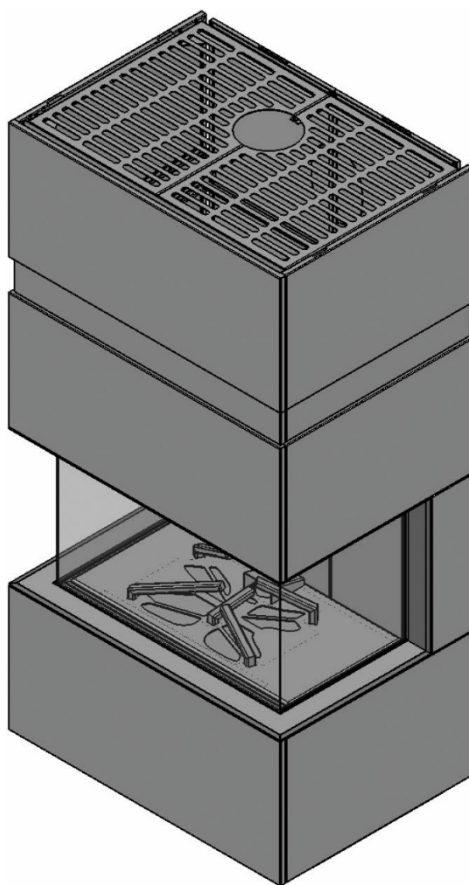

■ CONSERVATION

All maintenance must only be carried out on an extinguished and cooled appliance.

- Carry out periodic and timely maintenance - at least once a year an inspection of the fireplace by a specified service.
- The enclosure should not be cleaned with corrosive agents.
- Changes to the construction of the development are prohibited.
- When replacing parts, use only original parts from the manufacturer.

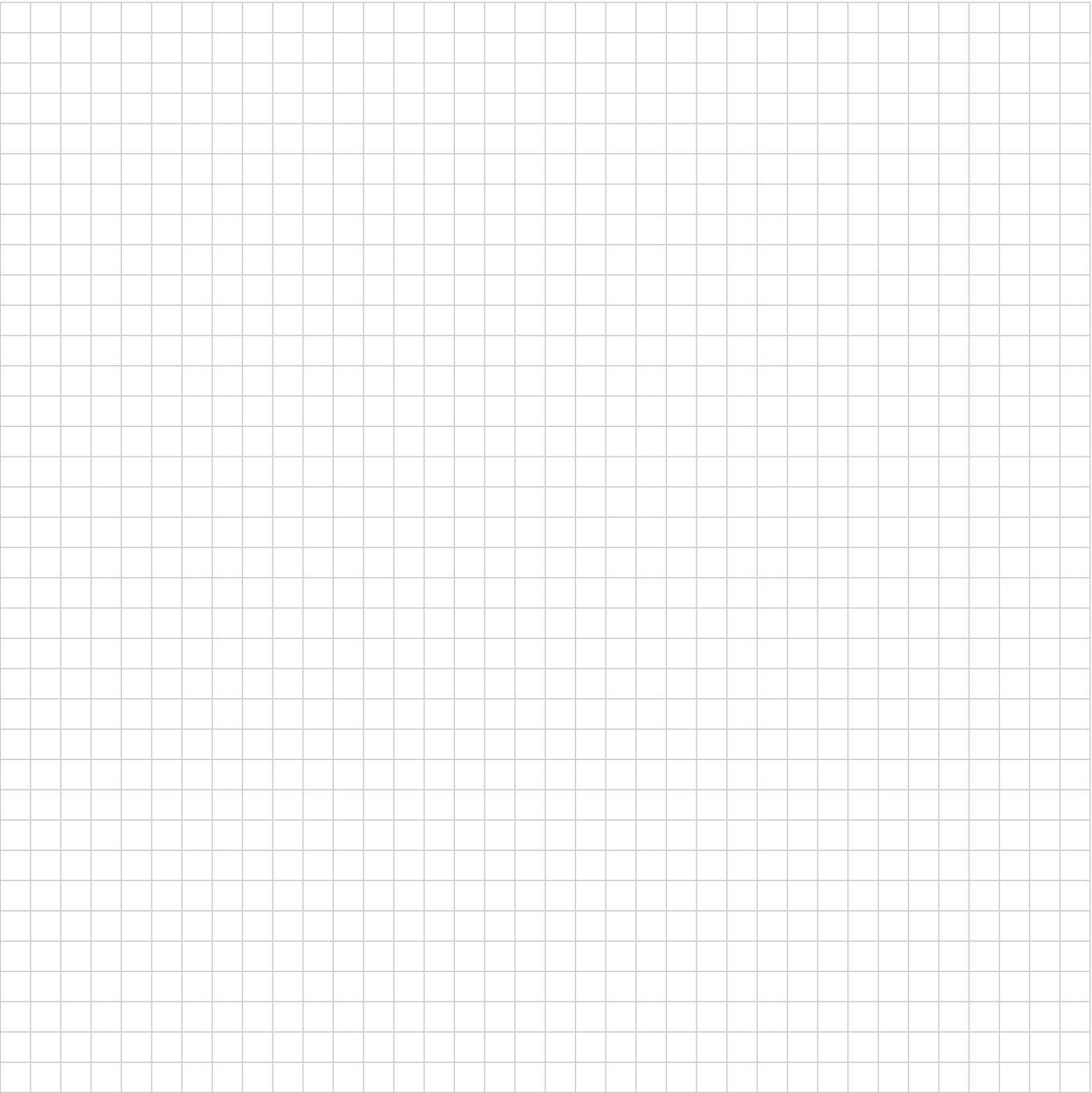

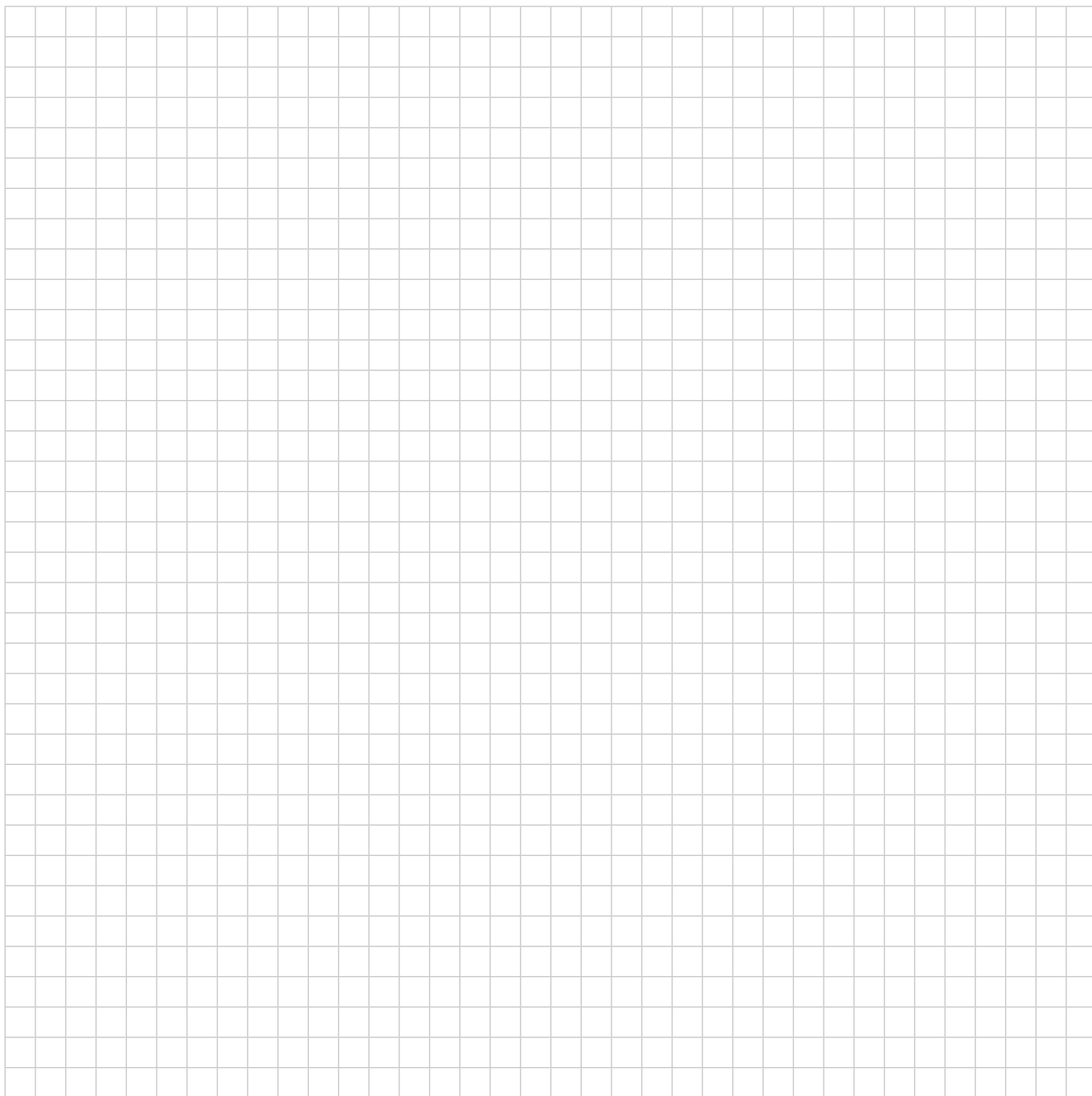

www.hitze.pl