

BASIC INFORMATION ABOUT THE PRODUCT



- A good choice for customers looking for an economical solution.
- Inserts made of high-quality P265GH boiler steel, which is resistant to continuous operation at elevated temperatures. A reinforced door profile was used.
- Manufacturing is carried out using modern machinery: welding robots, press brakes, laser cutters.
- Meets restrictive exhaust emission standards and ECODSIGN directives, thanks to the use of an exhaust afterburning system and two deflectors.
- Easy cleaning is ensured by a cast iron grate with a removable ash container.
- A built-in air intake with a damper allows you to adjust the amount of air supplied.
- A stylish black handle and DEKOR glass as standard.

Nominal power [kW]	9
Heating load range [kW]	4,5-11,5
Thermal efficiency [%]	81
CO emission (at 13% O2) [g/m3]	0,026
Dust emission [g/m3]	0,717
Average fuel consumption [kg/h]	2,7
Recommended outlet grille area [cm2]	630-720
Recommended inlet grille area [cm2]	360-590
Glass dimensions [mm]	543x390
Smoke diameter [mm]	177
Inlet diameter [mm]	123
Weight [kg]	105
Efficiency coefficient	108,5



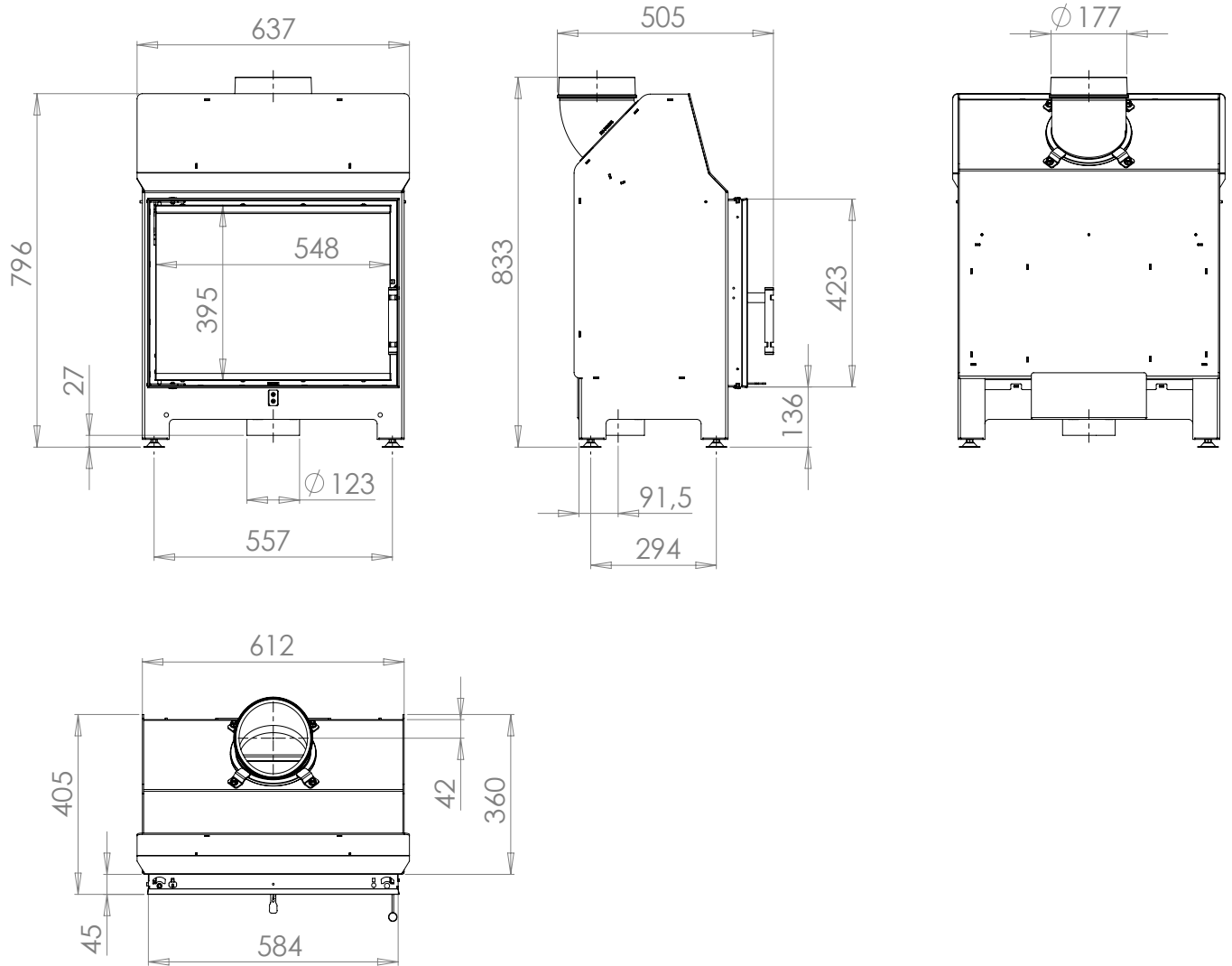

KARO